

# Inventor tutorial

# Start

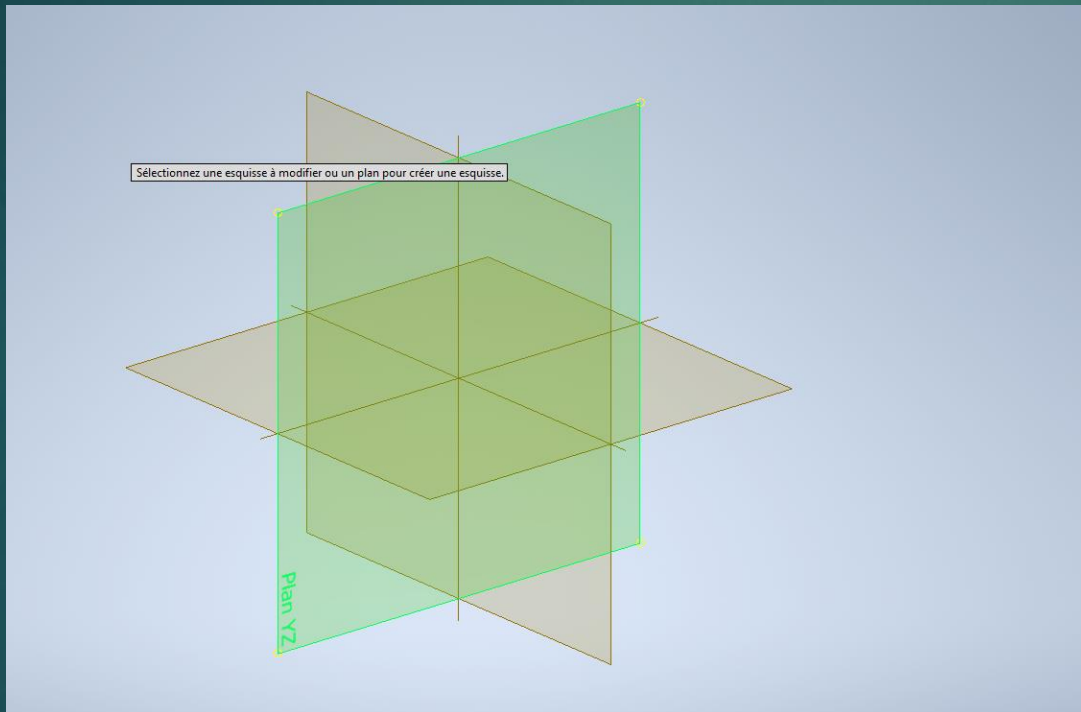
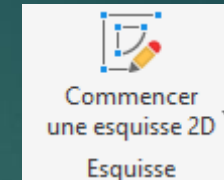

-To start, you have to click on the button (on top)  
-and select the plan (on the left)

For the tutorial you'll have to create different objects, you can name them what you want

# The blade 1 :

To create the blade you have to :

3 : to Recreate this select "arc" click here and here, place the line when you see this symbol :



and that's it

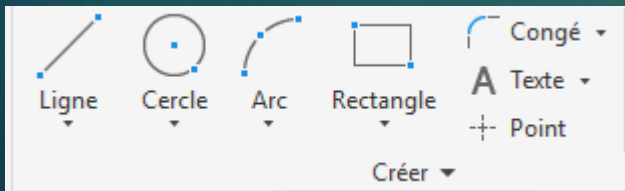

2 : recreate this patron

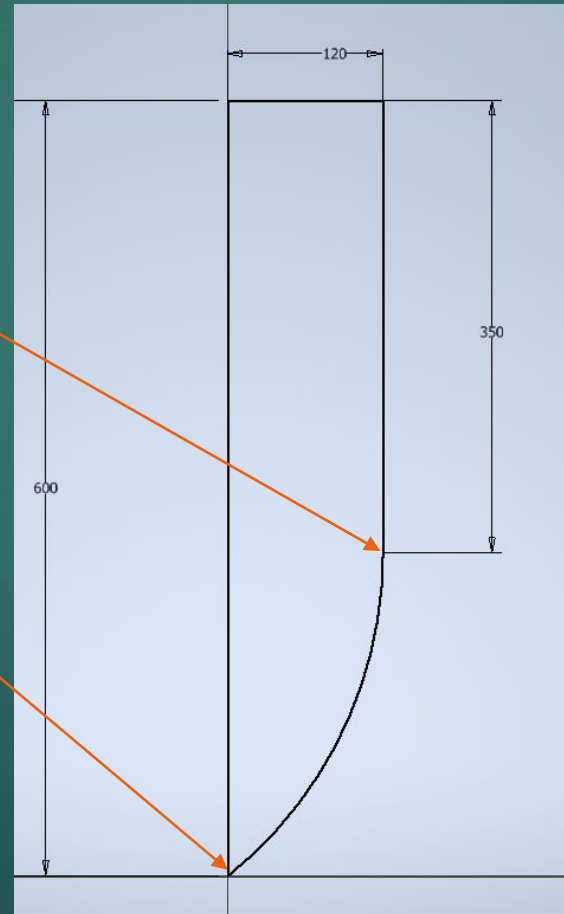

1 : create a line of 600 mm



# The blade 3 :

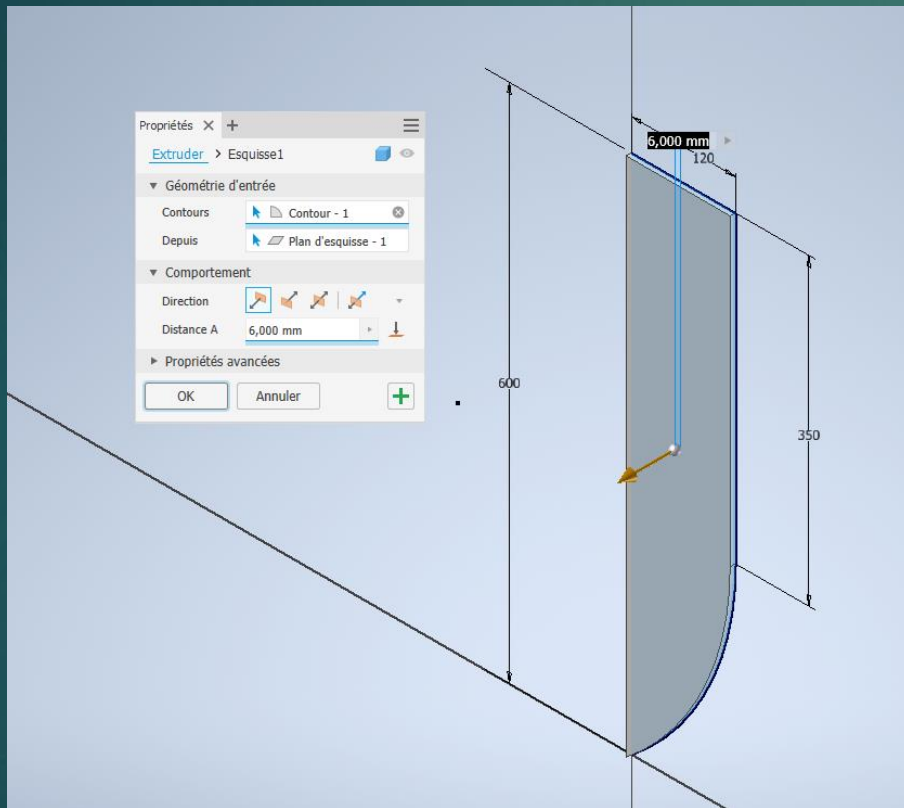

4 : Click on "extrusion" on your drawing and select 5mm

5 : that you have the blade, look to your new tools

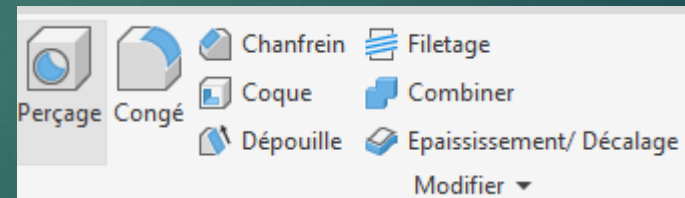

# The Blade 3 :

6 : Select the sharp of the blade with "chanfrein" and select 3mm

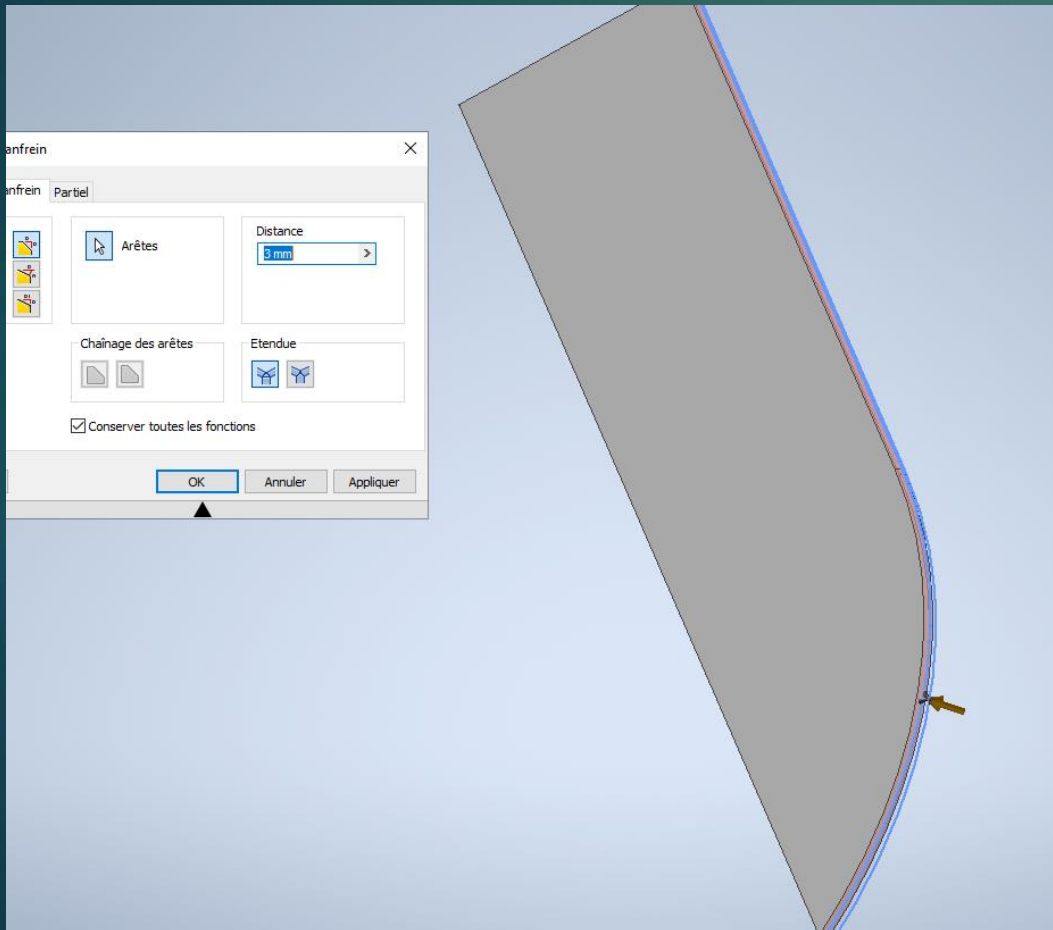

7 : Color the blade with the tool on top of inventor, you can put any color you want but i take black

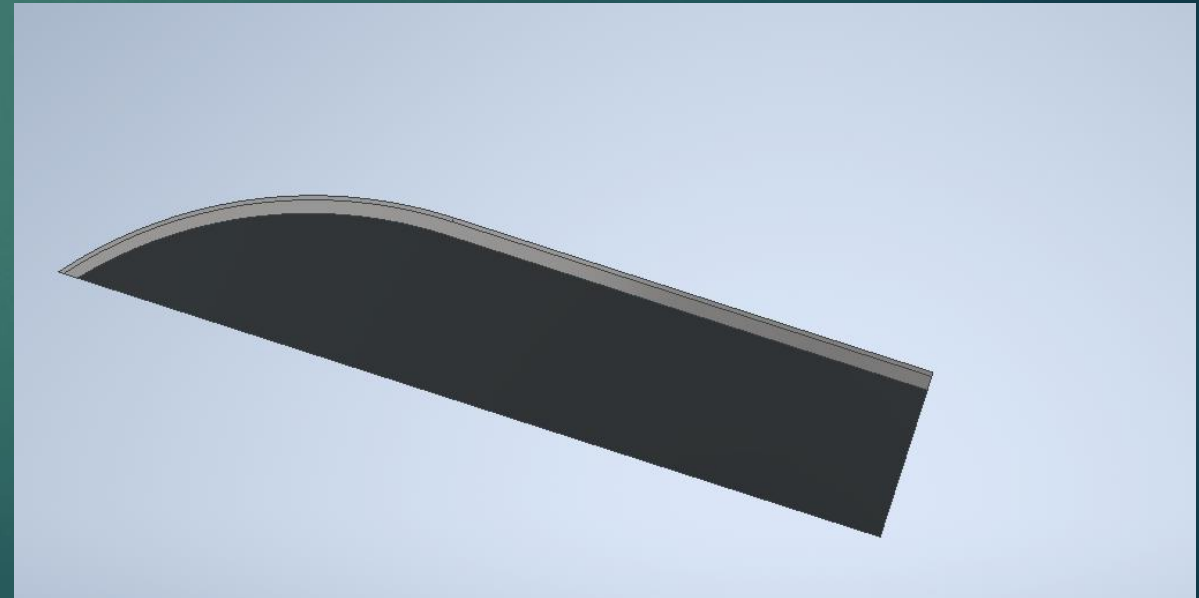

# Hand Guard 1:

8 : Ok, now the Hand guard, to do that create 2 new objects

10 : and another Rectangle but of 125 by 25 mm

9 : Then create a Rectangle of 150 mm by 50 mm, on a new esquisse (you can simply use the tool "rectangle")

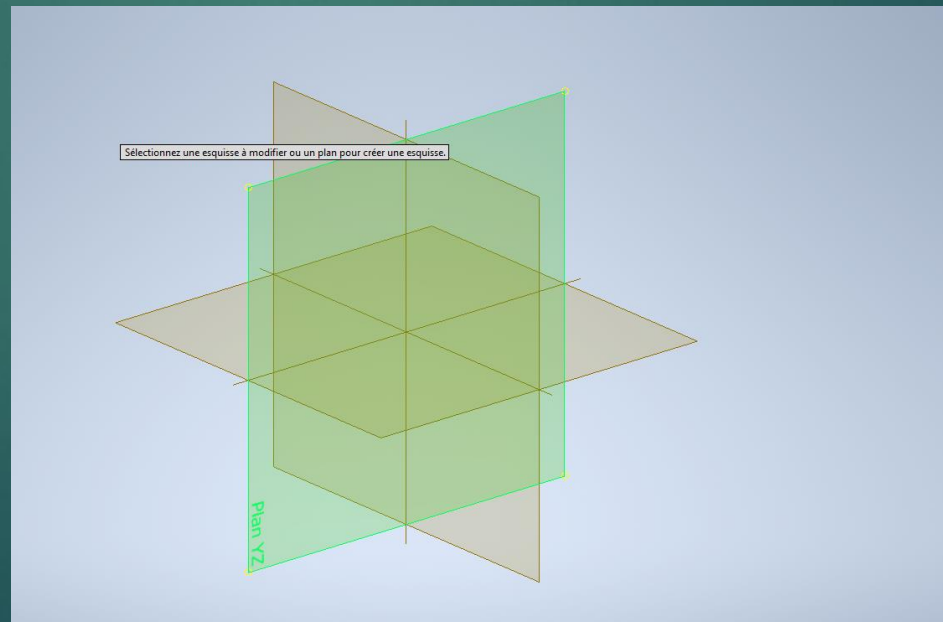
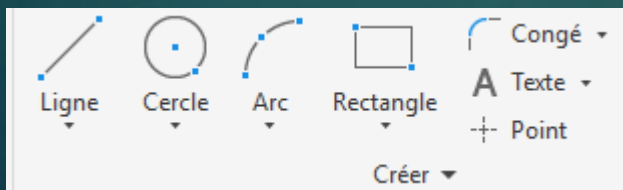

# Hand Guard 2 :

11 : do the same thing as for the blade with "extrusion" but with 10mm

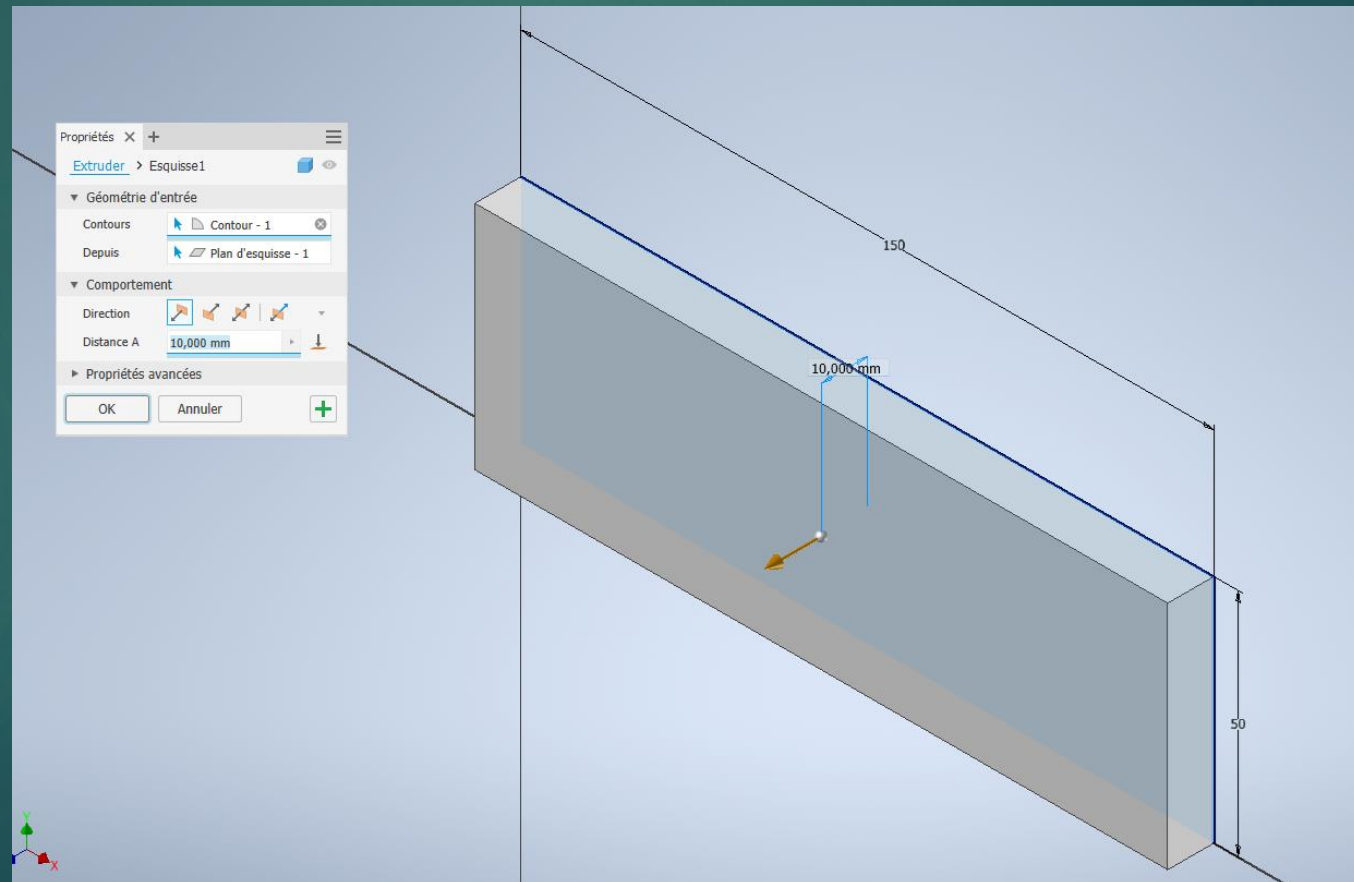

# Hand guard 3 :

(The lines have to be on the middle of each border lines)

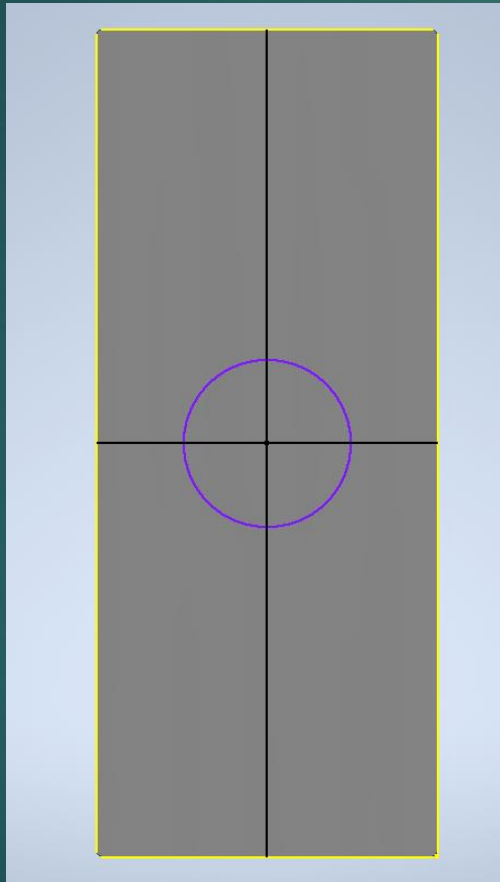

12 : create an Esquisse on the top of a rectangle and recreate the drawing here by using the tools : "Ligne" et "Cercle"

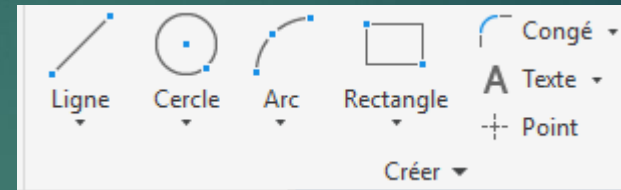

13 : Click on the tool "congé" and click on all the border lines and select 1mm in the column "rayon"

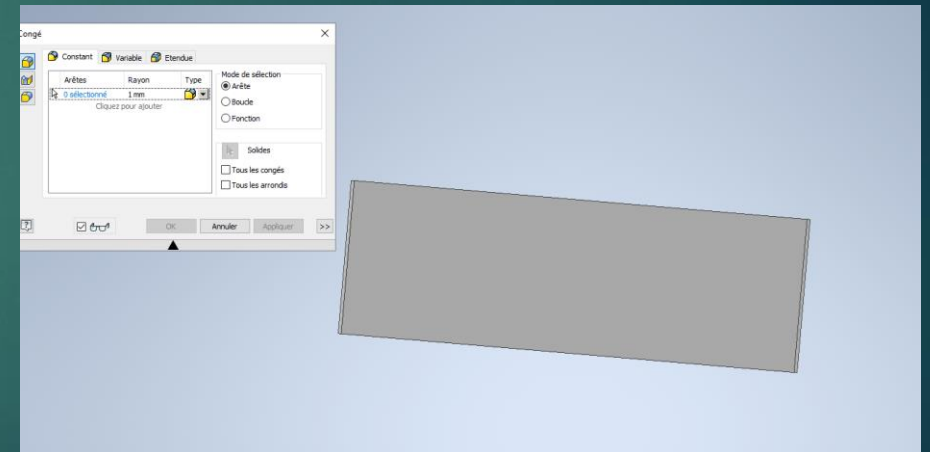

14 : do the same thing on the other rectangle



# The blade end :

15 : To finish the blade create a new "ensemble" and put all the objects we have created :



17 : put the blade on by searching the middle of this and put it on the two rectangle, you can also use the "axe" tool

16 : then use what we draw together , to do that click on the tool "contrainte" and select the middle of the two rectangle, if they don't assemble correctly don't panic and search for the "axe" tool, then create and "axe" on the center of the circle on each rectangles, then you can use the "contrainte" tool on the "axe"

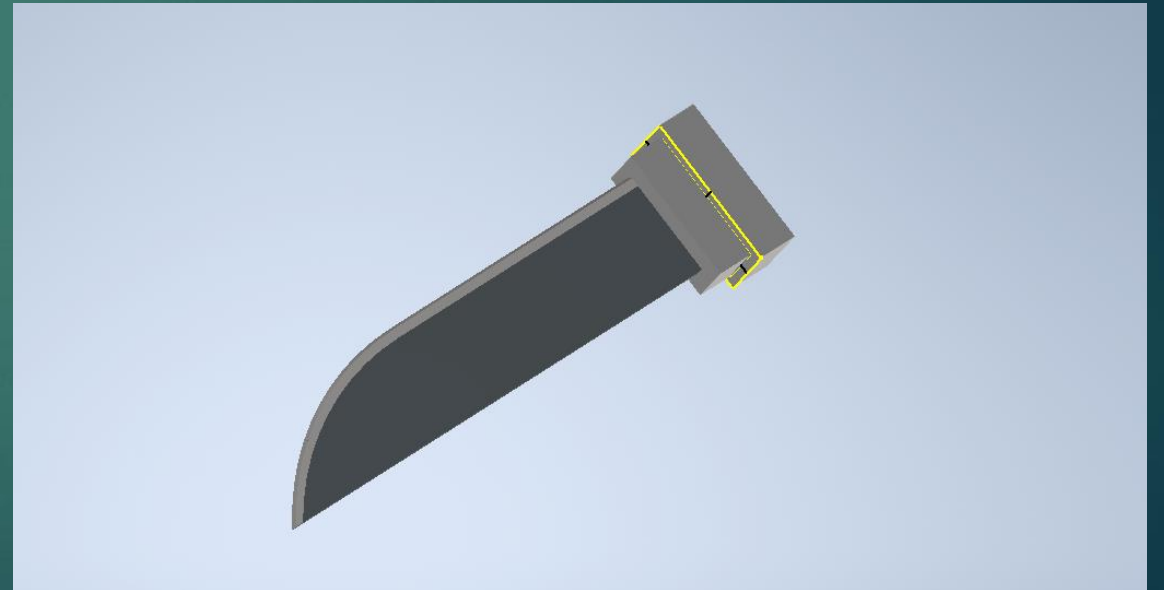

# The handle 1 :

18 : Create a new object and a new esquisse : then do a square like that :

19 : then use the tool "revolution" and select the square and the left border line

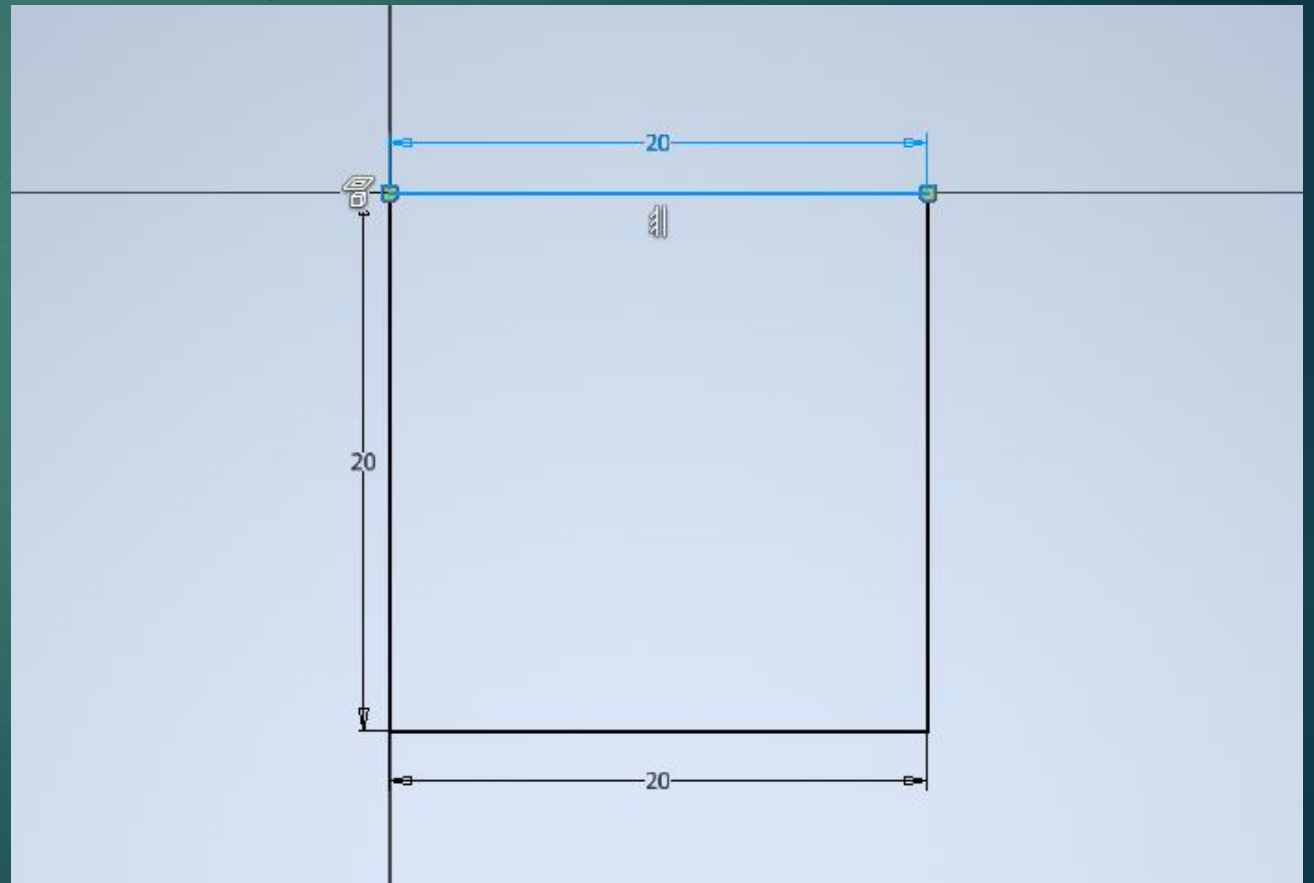

# The handle 2 :

19 : to recreate what you see, you simply have to create circle on top of each others : create a new esquisse, then select "Cercle" and do a circle of 30 mm on the center of the first circle you just created do an "extrusion" of 10mm and another of 20mm on top ,again "extrusion", and for the last do a circle of 30mm for the "extrusion" do 30mm ( you will adjust that later)

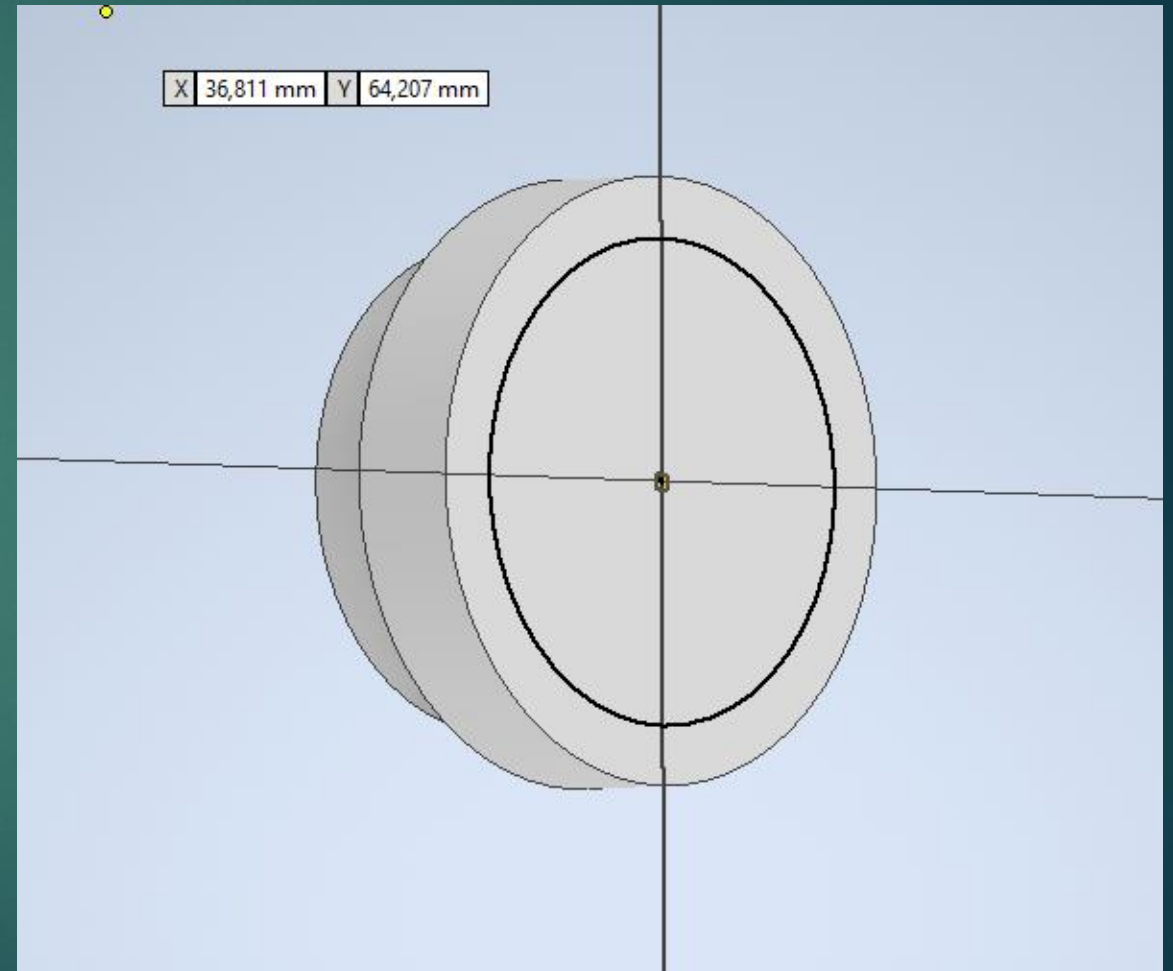
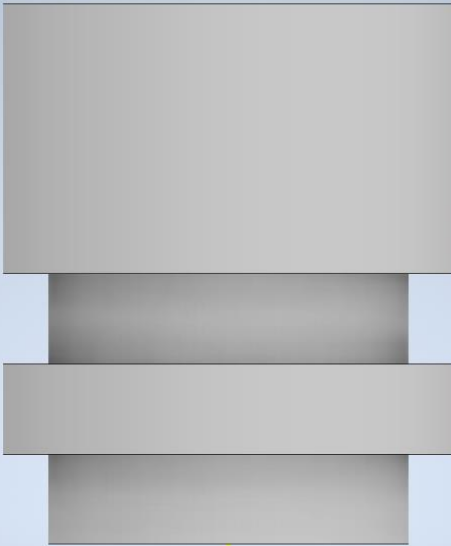

# The handle 3 :

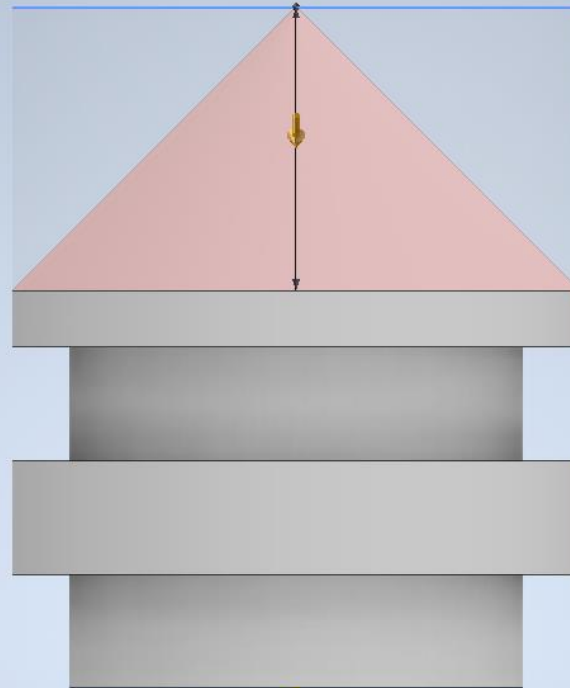
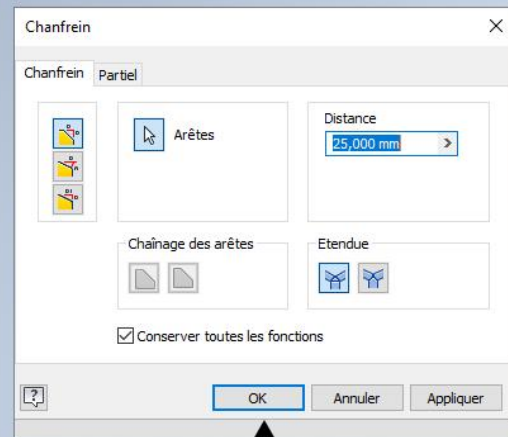

20 : Do a "Chanfrein" on the circle on the very top, select 25 mm for the chanfrein, if it's not like the photographie, juste adjust it manually with the yellow arrow you see

# The handle 4 :

21 : create a new object and to a rectangle of 200 mm by 20mm like this:

22 : then do a "revolution" like the square, you can put some color if you want

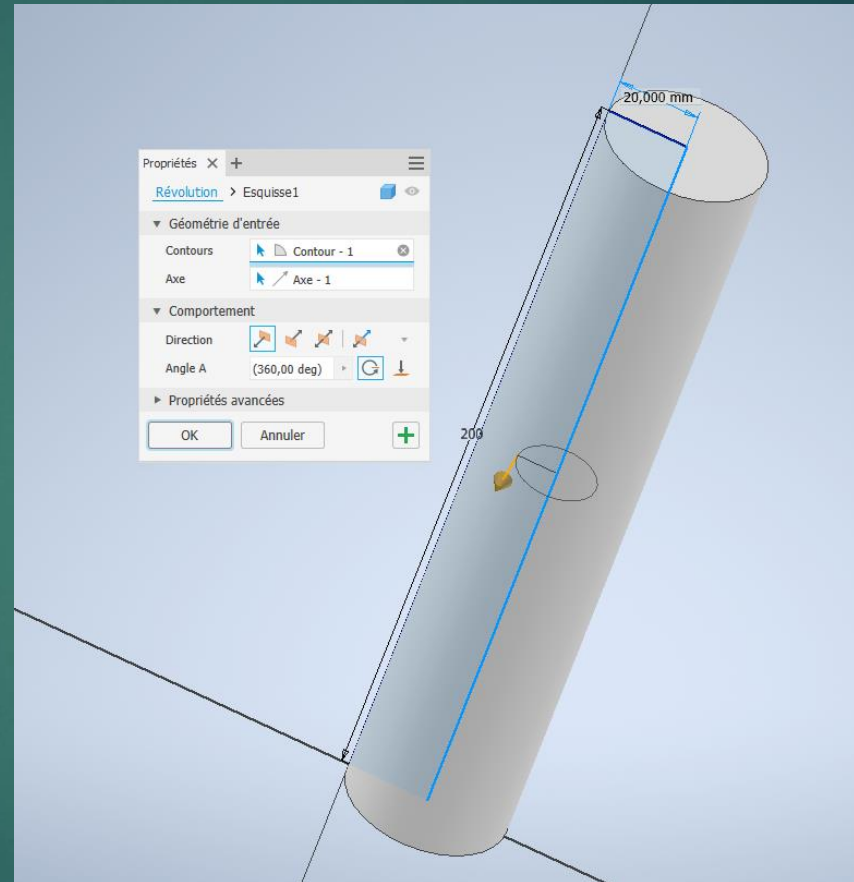

# The End 1 :

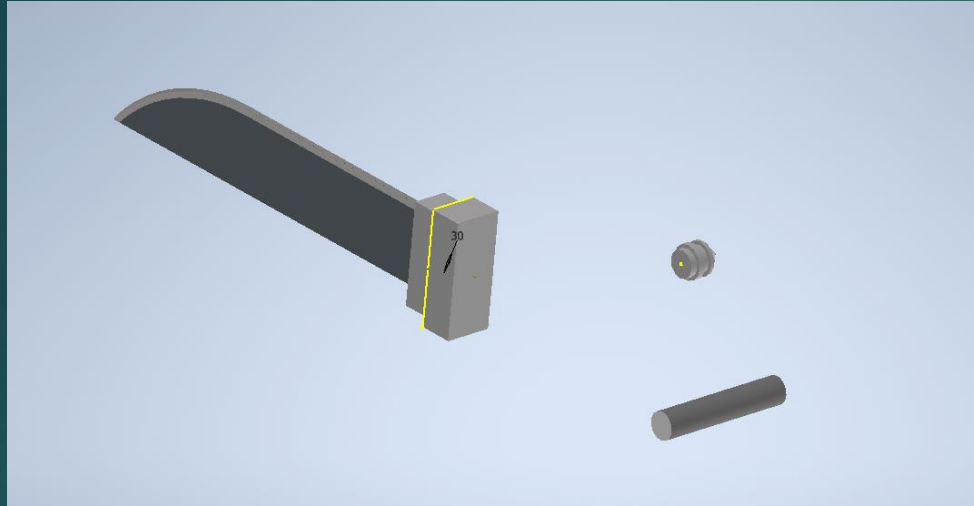

23 : put that all together in one "ensemble"

24 : create an "axe" on the two part of the handle, simply by clicking on the circle of each part



# Th end of the end



25 : Finish the sword by using  
"contrainte" on the "axe" like you use  
for the blade and Voilà you have your  
"training sword" from Genshin Impact

